

Product Safety Guide

Be sure to read this document before operating the Planar Motor system



Planar Motor Incorporated



WARNING!

- **Warning:** There is a risk of injury due to the strong magnets contained inside the XBOTs.
- **Warning:** The strong magnets may interfere with the operation of pacemakers and other related medical devices or equipment.
- All customers are required to take all necessary magnet-related precautionary measures to reduce the risk of injury. Under no circumstances will Planar Motor Inc. be responsible for any injury or damage caused by the strong magnets inside Planar Motor products.
- Planar Motor products are not fail-safe. Machine builders and automation system integrators are ultimately responsible for ensuring that the machines or systems containing Planar Motor products are brought to a safe state in the event of component failure.

XBOT Orientation

XBOT Top Side

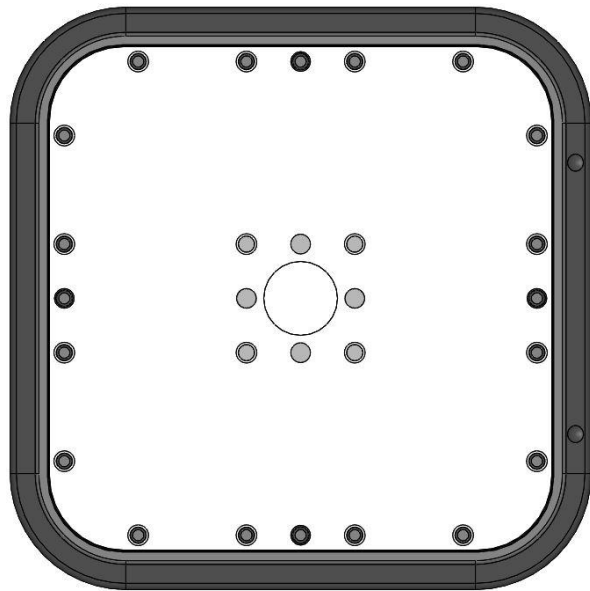

The top of the XBOT has a variety of mounting holes

XBOT Bottom Side

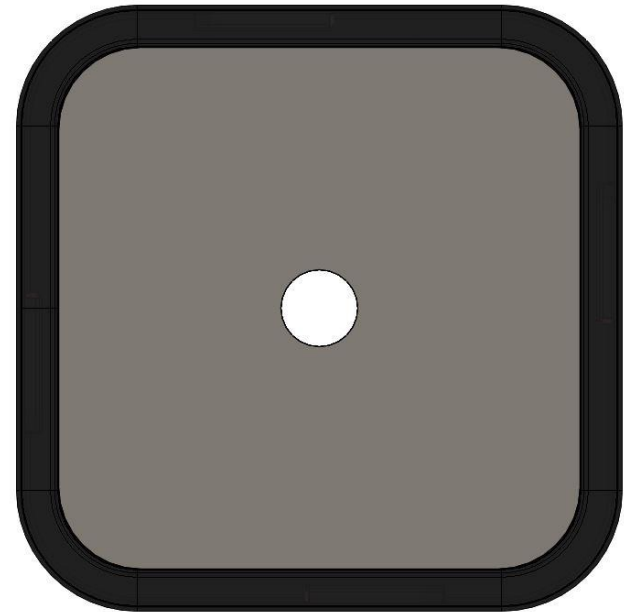

The bottom of the XBOT is a smooth surface without any mounting holes

XBOT Magnetic Field Strength

XBOT Top Side

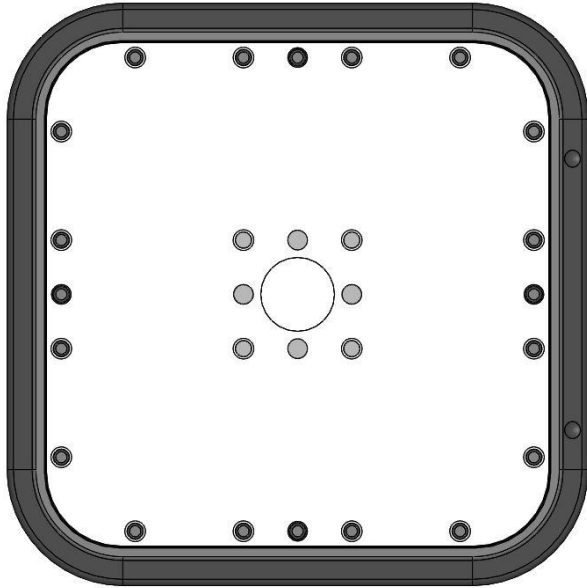

The magnetic field strength on this side of the XBOT is weak, but it is still dangerous to pacemaker users.

XBOT Bottom Side

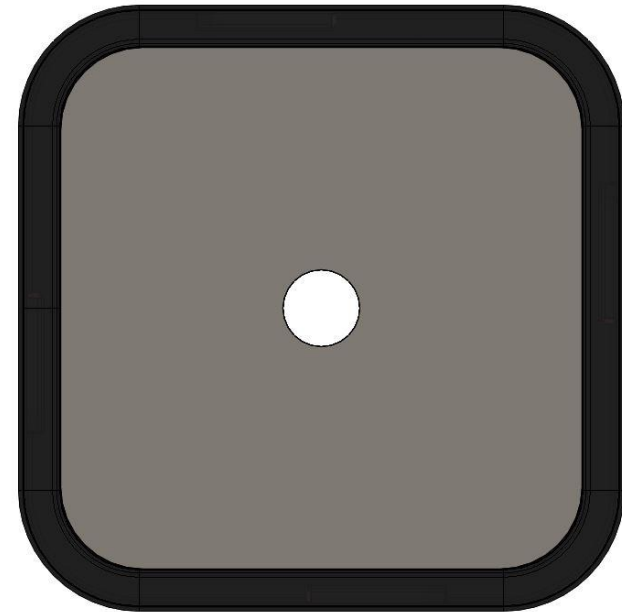

The magnetic field strength on this side of the XBOT is **VERY STRONG!** It will attract ferromagnetic materials even at a large distance. The attractive force is sufficient to cause significant injury to the user! **DO NOT** use a ferromagnetic materials based tool on or near the XBOT bottom!

XBOT Safety

Avoid tools with ferromagnetic components.
E.g. drill bits, knives, screwdrivers



Avoid tables with a ferromagnetic surface
e.g. steel tables



DO NOT use a ferromagnetic materials based tool on or near the bottom of the XBOT!
The tools may be suddenly attracted to the XBOT, harming the user



DO NOT place the XBOT near any furniture with ferromagnetic materials! (e.g. steel tables).
The XBOT may be suddenly attracted to the furniture, harming the user.

XBOT Placement on the Flyway

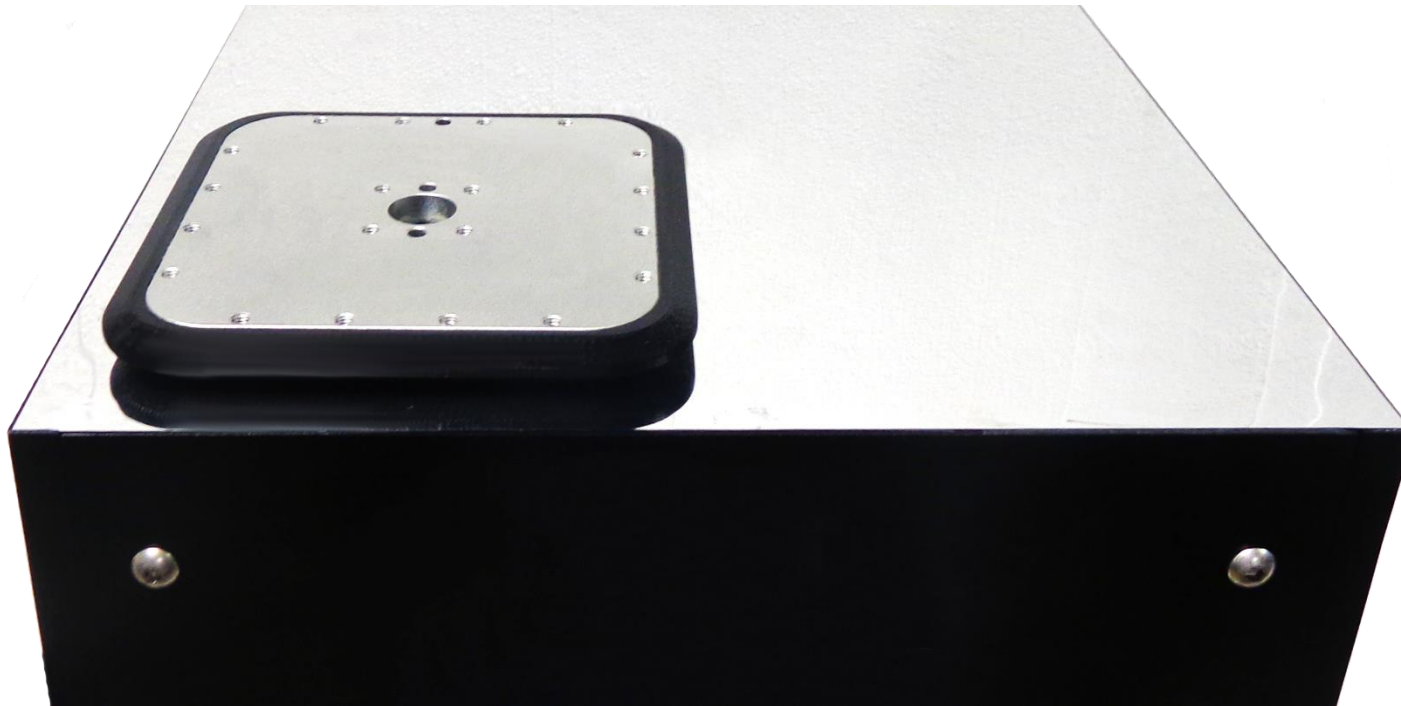

The XBOT must be placed with its **top side facing UP** on the Flyway.



DO NOT place an XBOT with its bottom side facing up on the Flyway! The strong magnetic field from the bottom side may attract components unexpectedly.



DO NOT place an XBOT with its bottom side exposed anywhere!

XBOT Handling

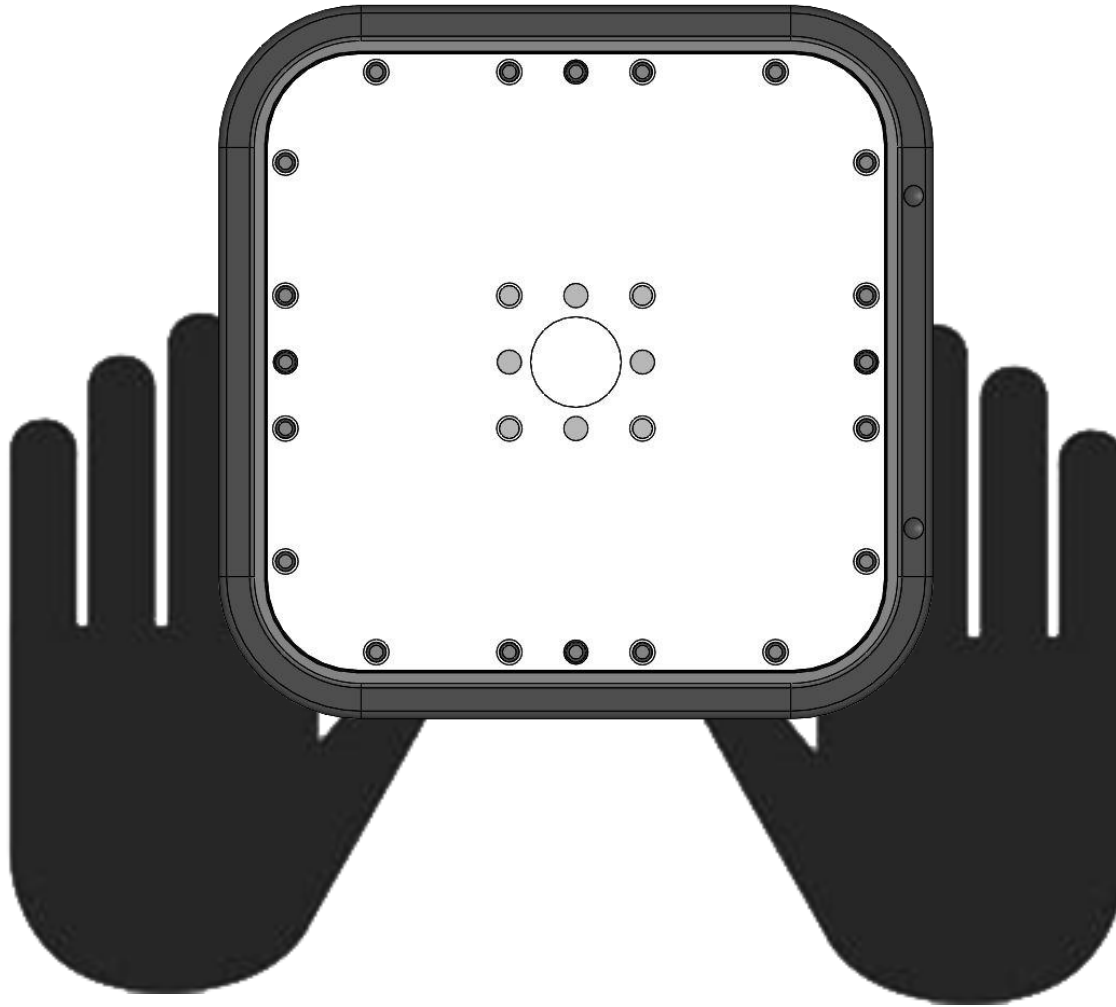

Always use BOTH hands to manually move the XBOT



DO NOT use one hand to hold an XBOT! The user may inadvertently drop the XBOT onto a ferromagnetic object!

XBOT Handling

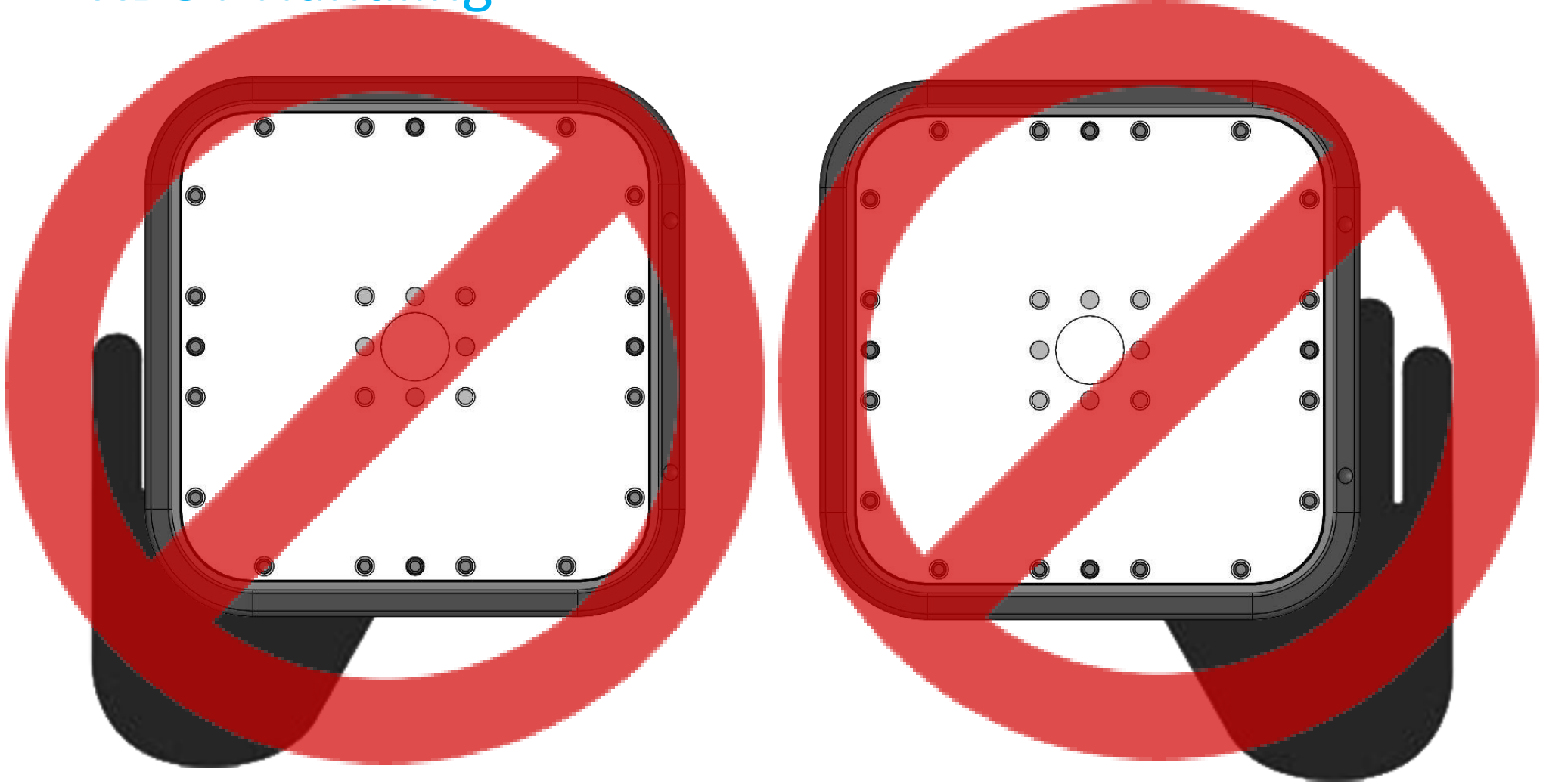

One user should NEVER HOLD TWO XBOTS AT THE SAME TIME! The XBOTS may be attracted to each other and harm the user's hands!



DO NOT hold an XBOT with one hand! The user may inadvertently drop the XBOT onto a ferromagnetic object!

XBOT Handling



NEVER move one XBOT over another XBOT! The XBOTs may be suddenly attracted to each other and harm the user's hand!

XBOT Storage



Always place XBOTs into the Planar Motor Inc provided storage box when not in use.

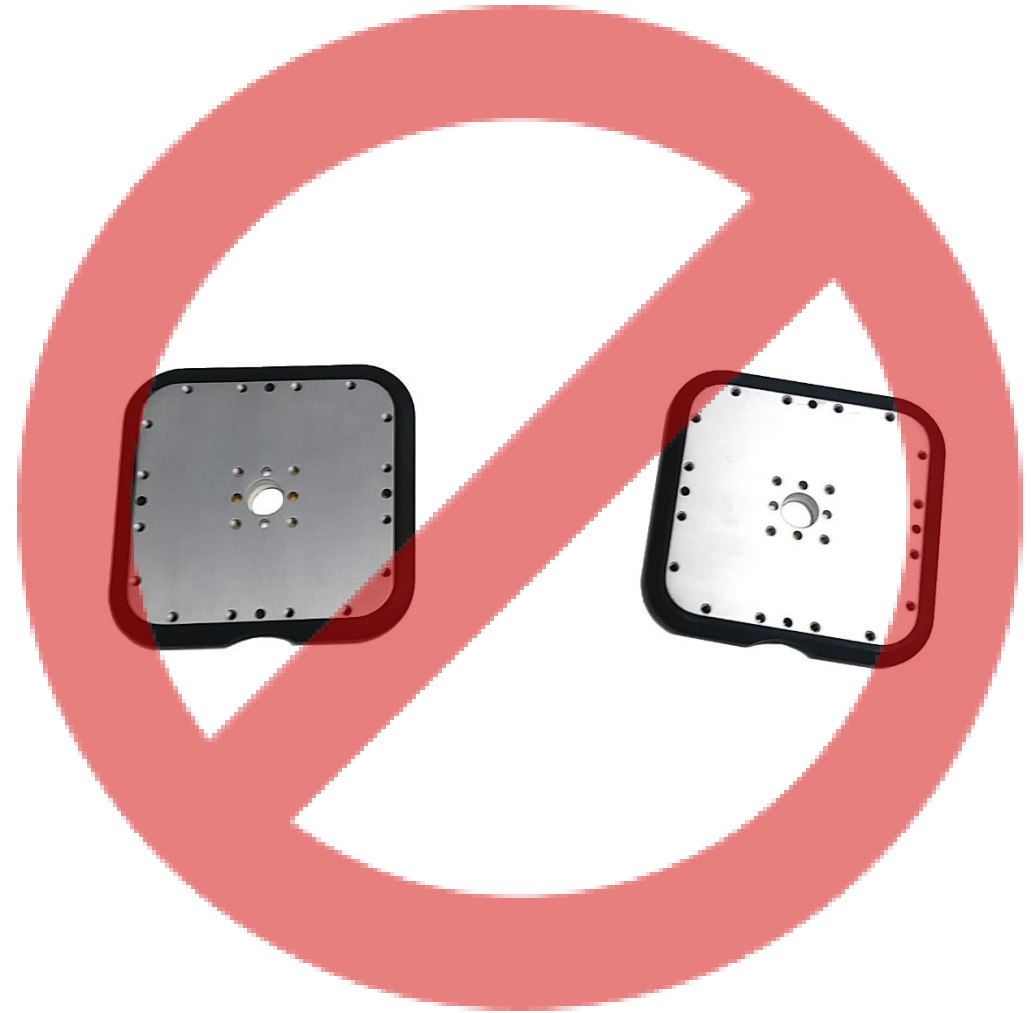

Never leave XBOTs outside of the storage box when the XBOTs are not on the Flyway! An untrained user may pick up an XBOT or may place a ferromagnetic object near the XBOT!

XBOT Storage



Always place XBOTS facing into the storage box facing the same direction.



Never place XBOTS facing into the storage box facing opposite directions! It is dangerous to have the strong side of the XBOT facing each other, especially during insertion and removal of the XBOT from the box